

~~KEEP-FILL~~[®]

Inventory Management Solutions

METBLUE BUTTON HEAD SOCKET CAP SCREW

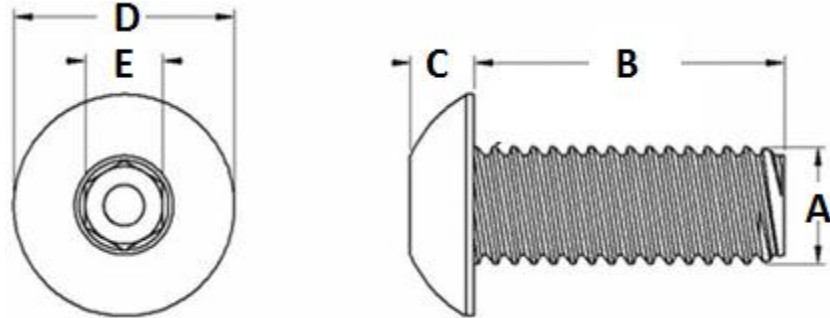

| | A | B | | C | D | E |
|-------------|-------------|-------------------|---------------|-------------|---------------|------------|
| PART NUMBER | THREAD SIZE | LENGTH UNDER HEAD | THREAD LENGTH | HEAD HEIGHT | HEAD DIAMETER | DRIVE SIZE |
| UST194860 | M3 - 0.50 | 8 | 8 | 1.6 | 5.7 | 2 |
| UST194861 | M3 - 0.50 | 10 | 10 | 1.6 | 5.7 | 2 |
| UST194862 | M3 - 0.50 | 12 | 12 | 1.6 | 5.7 | 2 |
| UST194863 | M3 - 0.50 | 16 | 16 | 1.6 | 5.7 | 2 |
| UST194947 | M3 - 0.50 | 20 | 20 | 1.6 | 5.7 | 2 |
| UST194864 | M4 - 0.70 | 8 | 8 | 2.2 | 7.6 | 2.5 |
| UST185175 | M4 - 0.70 | 10 | 10 | 2.2 | 7.6 | 2.5 |
| UST187479 | M4 - 0.70 | 12 | 12 | 2.2 | 7.6 | 2.5 |
| UST194865 | M4 - 0.70 | 16 | 16 | 2.2 | 7.6 | 2.5 |
| UST187480 | M4 - 0.70 | 20 | 20 | 2.2 | 7.6 | 2.5 |
| UST187481 | M4 - 0.70 | 25 | 25 | 2.2 | 7.6 | 2.5 |
| UST187482 | M5 - 0.80 | 10 | 10 | 2.8 | 9.5 | 3 |
| UST187483 | M5 - 0.80 | 12 | 12 | 2.8 | 9.5 | 3 |
| UST194867 | M5 - 0.80 | 16 | 16 | 2.8 | 9.5 | 3 |
| UST187484 | M5 - 0.80 | 20 | 20 | 2.8 | 9.5 | 3 |
| UST187485 | M5 - 0.80 | 25 | 25 | 2.8 | 9.5 | 3 |
| UST187486 | M5 - 0.80 | 30 | 30 | 2.8 | 9.5 | 3 |
| UST187521 | M6 - 1 | 10 | 10 | 3.3 | 10.5 | 4 |
| UST187487 | M6 - 1 | 12 | 12 | 3.3 | 10.5 | 4 |
| UST187523 | M6 - 1 | 16 | 16 | 3.3 | 10.5 | 4 |
| UST187524 | M6 - 1 | 20 | 20 | 3.3 | 10.5 | 4 |
| UST187489 | M6 - 1 | 25 | 25 | 3.3 | 10.5 | 4 |
| UST187490 | M6 - 1 | 30 | 30 | 3.3 | 10.5 | 4 |
| UST187491 | M6 - 1 | 35 | 35 | 3.3 | 10.5 | 4 |

~~KEEP-FILL~~[®]

Inventory Management Solutions

METBLUE BUTTON HEAD SOCKET CAP SCREW

| | A | B | | C | D | E |
|-------------|-------------|-------------------|---------------|-------------|---------------|------------|
| PART NUMBER | THREAD SIZE | LENGTH UNDER HEAD | THREAD LENGTH | HEAD HEIGHT | HEAD DIAMETER | DRIVE SIZE |
| UST187525 | M8 - 1.25 | 10 | 10 | 4.4 | 14 | 5 |
| UST187526 | M8 - 1.25 | 12 | 12 | 4.4 | 14 | 5 |
| UST187527 | M8 - 1.25 | 16 | 16 | 4.4 | 14 | 5 |
| UST187528 | M8 - 1.25 | 20 | 20 | 4.4 | 14 | 5 |
| UST187494 | M8 - 1.25 | 25 | 25 | 4.4 | 14 | 5 |
| UST187495 | M8 - 1.25 | 30 | 30 | 4.4 | 14 | 5 |
| UST187496 | M8 - 1.25 | 35 | 35 | 4.4 | 14 | 5 |
| UST187497 | M8 - 1.25 | 40 | 40 | 4.4 | 14 | 5 |
| UST187529 | M10 - 1.50 | 16 | 16 | 5.5 | 17.5 | 6 |
| UST187530 | M10 - 1.50 | 20 | 20 | 5.5 | 17.5 | 6 |
| UST187531 | M10 - 1.50 | 25 | 25 | 5.5 | 17.5 | 6 |
| UST194476 | M10 - 1.50 | 30 | 30 | 5.5 | 17.5 | 6 |
| UST194869 | M10 - 1.50 | 35 | 35 | 5.5 | 17.5 | 6 |
| UST194870 | M10 - 1.50 | 40 | 40 | 5.5 | 17.5 | 6 |
| UST198752 | M10 - 1.50 | 50 | 50 | 5.5 | 17.5 | 6 |
| UST194872 | M12 - 1.75 | 20 | 20 | 6.6 | 21 | 8 |
| UST194873 | M12 - 1.75 | 25 | 25 | 6.6 | 21 | 8 |
| UST194874 | M12 - 1.75 | 30 | 30 | 6.6 | 21 | 8 |